



68-74 THOMPSON STREET

NEW YORK, NEW YORK



## Property Overview

- Prime retail location in Soho, one of New York's most densely populated retail neighborhoods.
- Skylight in Lower Level
- Neighboring tenants include Sugarfish by Sushi Nozawa, Hotel Sixty, Laudree Soho, Pera Soho, Vin Et Fleurs
- Walking distance from ACE subway lines

**CONTACT: MICHAEL ROBBINS** | T: 212-951-3828 F: 212-545-1355 | [mrobbins@pihc.com](mailto:mrobbins@pihc.com)

All areas and dimensions are approximate. This plan is intended for identification purposes only and is not to be deemed a representation by Landlord as to the accuracy or square footage.

Philips International | 40 Cutter Mill Road, Suite 405, Great Neck, NY 11021





# 68-74 THOMPSON STREET

NEW YORK, NEW YORK

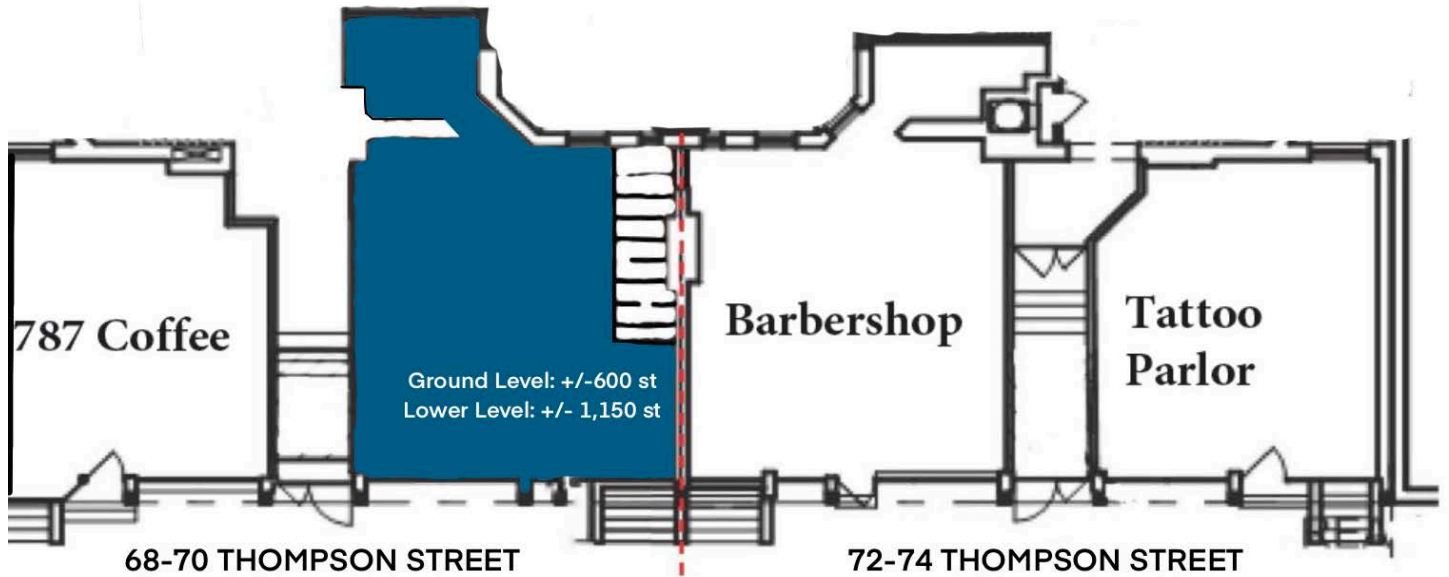

- Leased
- Available

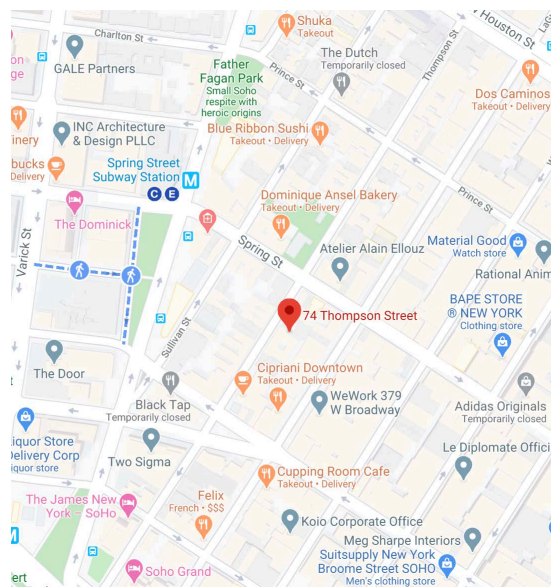

**CONTACT: MICHAEL ROBBINS** | T: 212-951-3828 F: 212-545-1355 | [mrobbins@pihc.com](mailto:mrobbins@pihc.com)

All areas and dimensions are approximate. This plan is intended for identification purposes only and is not to be deemed a representation by Landlord as to the accuracy or square footage.

